

S1-F(WZ)

Zigbee + RF Single Line AC Phase Cut RF Dimmer

- RF + AC Push +single line phase cut dimmer, 1 channel output.
- To dim and switch single color dimmable LED lamps, traditional incandescent and halogen lights.
- Tuya APP cloud control, support on/off, brightness adjust, delay turn on/off light, timer run, scene and music play function.
- Philips HUE APP control by connect with Philips HUE bridge.
- Voice control, support for Amazon Alexa, Google Assistant, Tmall Genie and Xiaodu smart speakers.
- 256 levels 0-100% dimming smoothly without any flash.
- Min brightness can be set by key.
- Light on/off fade time 3s selectable.
- Compatibility with RF 2.4G single zone or multiple zone dimming remote control.
- Connect with AC push switch to achieve on/off and 0-100% dimming function.
- Easy to be placed in standard wall junction box behind a push switch.
- Over-heat / Over-load protection, recover automatically.

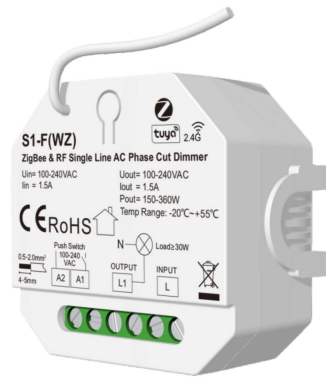

Technical Parameters

Input and Output		Dimming data		Safety and EMC	
Input voltage	100-240VAC	Input signal	Tuya APP + RF + Push Dim	EMC standard (EMC)	ETSI EN 301 489-1 V2.2.3 ETSI EN 301 489-17 V3.2.4
Output voltage	100-240VAC	Control distance	30m(Barrier-free space)	Safety standard	EN 62368-1:2020+A11:2020
Input current	1.5A	Dimming gray scale	256 level	Certification	CE,EMC
Output current	1.5A	Dimming range	0-100%	Environment	
Output power	150-360W	Package		Operation temperature	Ta: -20°C ~ +55°C
Warranty and Protection		Size	L 60xW60xH40mm	Case temperature (Max.)	Tc: +85°C
Warranty	5 years	Gross weight	0.069kg	IP rating	IP20
Protection	Over-heat, Over-load				

Compatible Load Types

Load Type	Maximum Load	Remarks
Dimmable LED lamps	200W @ 220V 100W @ 110V	Due to variety of LED lamp designs, maximum number of LED lamps is further dependent on power factor result when connected to dimmer.
Incandescent lighting, HV Halogen lamps	400W @ 220V 200W @ 110V	

Mechanical Structures and Installations

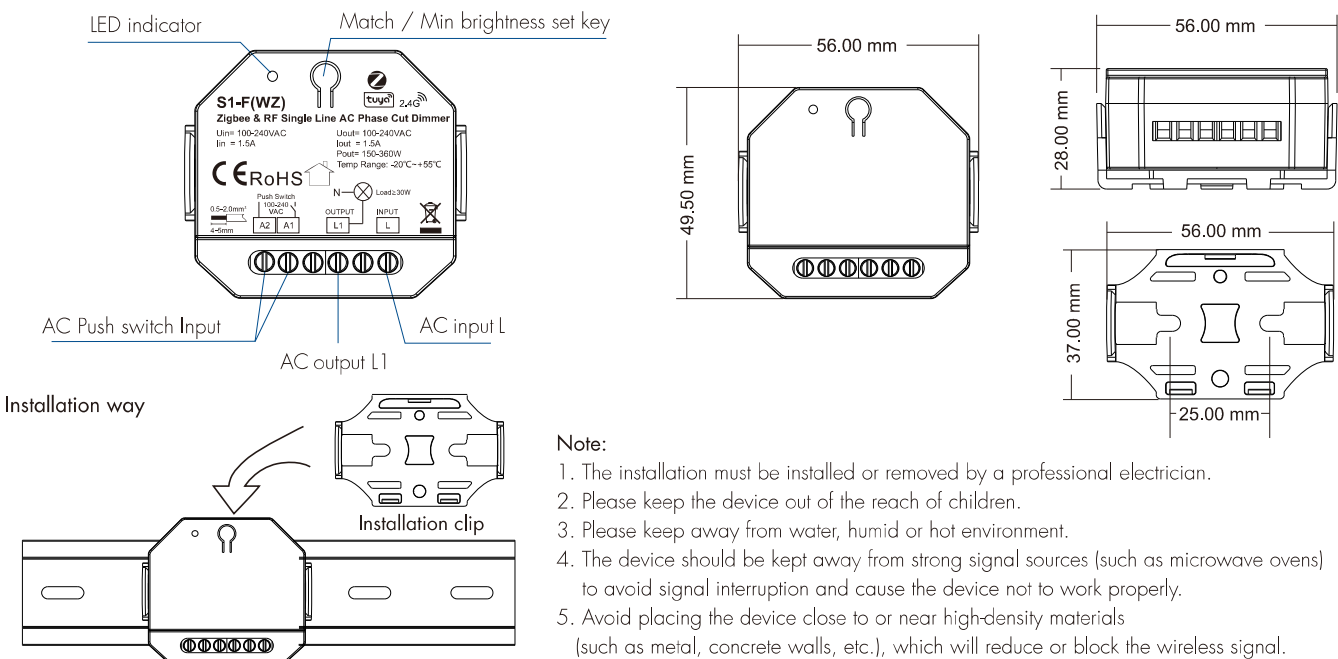

System wiring

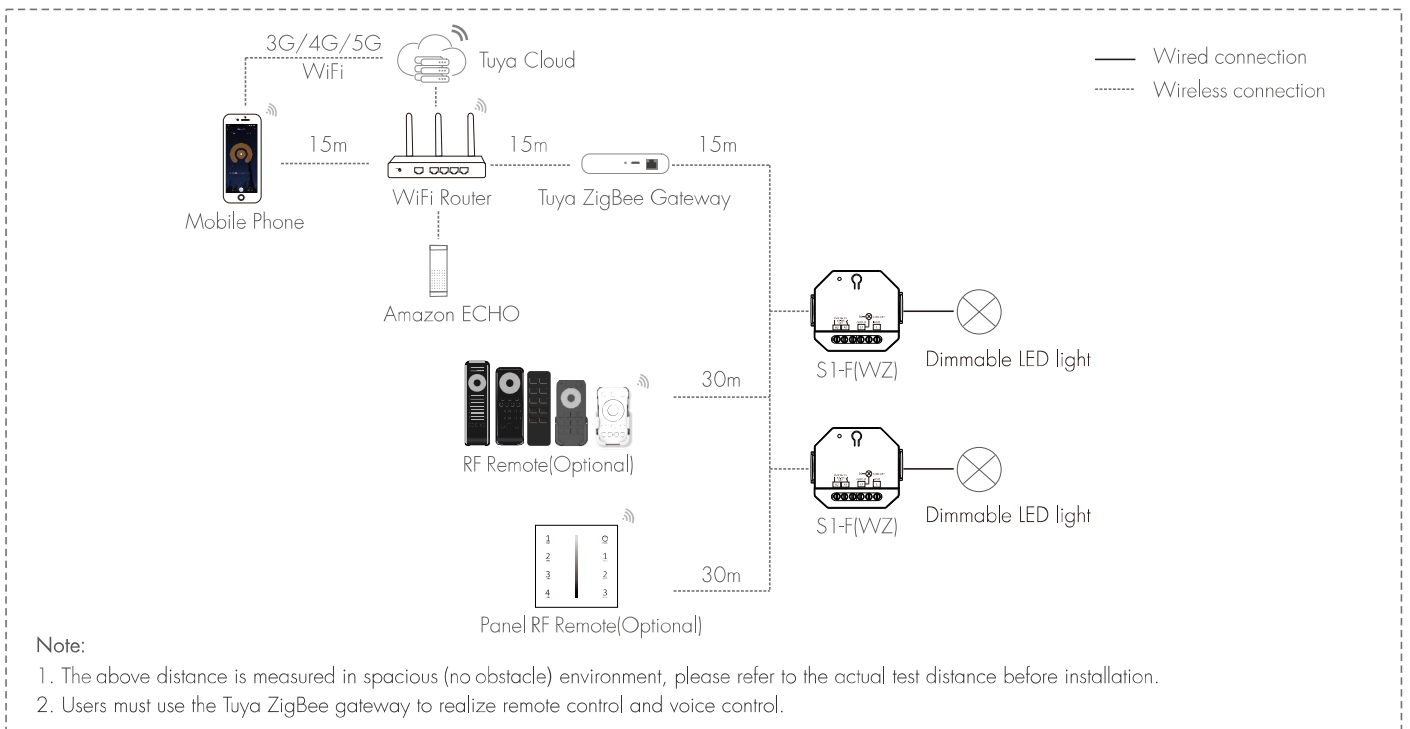

Wiring diagram

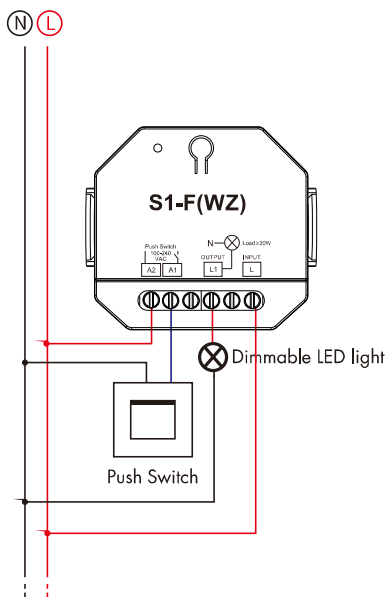

⚠ Caution: Please carefully ensure all wire connections and polarities are correct and secure before applying power, otherwise this dimmer will be damaged.

Note:

1. To work properly, the single line phase cut dimmer of the connected load lamps should be $\geq 30W$.
2. When calculating the maximum number of load lamps, the input power or input current parameters of a single lamp must be used, the output power parameters can not be used.

In addition, the maximum surge current of the dimmer is 65A, the sum of surge current of multiple dimmable LED lamps should not exceed 2 times, otherwise, the product will be overloaded and damaged.

Push dim function

- **Short press:** Turn on or off light.
- **Long press (1-6s):** Press and hold to step-less dimming, With every other long press, the light level goes to the opposite direction.
- **Dimming memory:** Light returns to the previous dimming level when switched off and on again, even at power failure.

Min brightness setting

Long press Min set key for 10s, the light blink 2 times, ready for min brightness set, then short press Min set key 1-4 times, to get 4 min brightness: 5%, 10%, 15%, 20%, the light will output the current min brightness immediately, wait 5s, quit min brightness set, the light will output 100% brightness automatically.

Light on/off fade time

Switch off the power, then switch on power, repeat again, then short press Match key 3 times, the light on/off time will be set to 3s, the indicator light blink 3 times. Long press Match key 20s, restore factory default parameter, min light brightness is 5%, on/off fade time is 0.5s.

APP operating instruction

Please download the corresponding Tuya/Smart life App according to your region.

Press and hold Match/Set key for 2s, reset ZigBee network.

Press and hold Match/Set key for 5s, or push twice Match/Set key fastly, Clear previous network connection, enter config mode. the blue LED indicator fast flash.

If Tuya APP network connection succeed, the blue LED indicator will stop flash, and in Tuya APP, you can find ZB3.0-DIM device.



Smart life APP



Tuya APP

APP interface

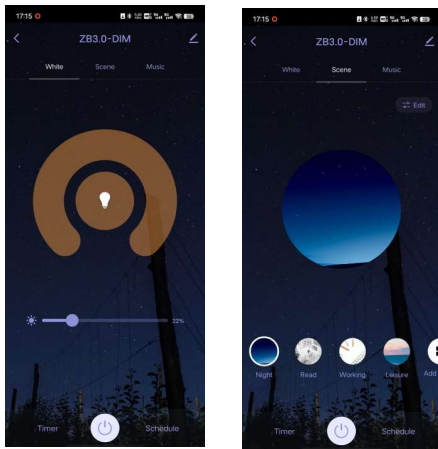

Switch interface

Touch on/off key to turn on or off light.

The Timer can be set to automatically turn on or off lights for the next 24 hours

The schedule can be add multiple timers to turn on or off the lights according to different times.

Scene interface

The 1-4 scene is static color.

the inner brightness of these scene can be editable.

S1-F(WZ) Match RF remote control (two match ways)

End user can choose the suitable match/delete ways. Two options are offered for selection:

Use the controller's Match key

Match:

Short press match key, immediately press on/off key (single zone remote) or zone key (multiple zone remote) on the remote.

The LED indicator fast flash a few times means match is successful.

Delete:

Press and hold match key for 1.5s to delete all match,

The LED indicator fast flash a few times means all matched remotes were deleted.

Use Power Restart

Match:

Switch off the power, then switch on power, repeat again. Immediately short press on/off key (single zone remote) or zone key (multiple zone remote) 3 times on the remote. The light blinks 3 times means match is successful.

Delete:

Switch off the power, then switch on power, repeat again. Immediately short press on/off key (single zone remote) or zone key (multiple zone remote) 5 times on the remote. The light blinks 5 times means all matched remotes were deleted.

S1-F(WZ) work as Zigbee-RF converter to match other RF switch or controller

User can choose the suitable match/delete ways. Two options are offered for selection:

Use the controller's Match key

Match:

Short press match key of the controller, immediately press on/off key on the Tuya APP.

The LED indicator fast flash a few times means match is successful.

Delete:

Press and hold match key of the controller for 5s,

The LED indicator fast flash a few times means match was deleted.

Use Power Restart

Match:

Switch off the power of the controller, then switch on power, repeat again, Immediately short press on/off key 3 times on the Tuya APP.

The light blinks 3 times means match is successful.

Delete:

Switch off the power of the controller, then switch on power, repeat again,

Immediately short press on/off key 5 times on the Tuya APP.

The light blinks 5 times means match was deleted.